



1200°C

Electric Muffle Furnace

The muffle furnaces FM series are the right choice for daily laboratory use. These models stand out for their excellent workmanship, advanced and attractive design, and high level of reliability. The muffle furnaces equipped with professional programmer and come with 4 volume: 2, 4, 6 and 8 Liters



Unique Ceramic Heating Plates

- Integral heating element which is safeguarded against fumes and splashing
- Low temperature external case
- High energy efficiency
- High shock resistant
- Easy to replace



Professional Programmer

- Adjustable temp, time and thermal ramp in each step
- 1 program with 100 steps
- 2 program with 25 steps
- Advanced smart timer



Inner chamber

- Heating from two sides by ceramic heating plates
- No use of asbestos for user health
- Exhaust air outlet

Electric Muffle Furnaces

Main Features

- External case coated with electrostatic powder paint
- 999-hours smart timer (permanently operable)
- Temperature uniformity in the whole chamber
- Equipped with central troubleshooting system
- Equipped with Error Alarm
- High shock resistance
- No use of asbestos





Special Benefits

Utilizing the latest and most accurate microcontrollers

- Professional program which can store 2 programs of 25 steps and one program 100 steps
- Excellent temporal and spatial temperature accuracy
- Solid state relay provide for low-noise operation
- 999-hours smart timer (permanently operable)
- Vast operating range from 100°C up to 1200°C
- Central troubleshooting system
- Adjustable thermal ramp
- PID controller

Ceramic Heating Plates

- Temperature uniformity throughout the whole surface
- Temperature stability and reproducibility
- State guard against fumes and splashing
- Low temperature external case
- High energy efficiency
- High shock resistance
- Short warm up times
- Easy to replace

Outer body

- Special design of the outer body for efficient use of laboratory space
- Very tight door closure with 2-point door latch
- Beautiful and ergonomic design
- Light weight

Inner chamber

- No use of asbestos for users health
- Heating from two sides
- Exhaust air out let

Electric Muffle Furnaces

Specifications

Exterior dimensions	FM 2 P	FM 4 P	FM 6 P	FM 8 P
Width (cm)	42	51	52	52
Height (incl. feet) (cm)	61	61	63	71
Depth (cm)	44	47	53	44
Depth Plus door handle and connection (cm)	49	52	58	49
Wall clearance, rear (cm)	10	10	10	10
Wall clearance, side (cm)	15	15	15	15
Weight (empty) (kg)	28	30	32	34
Interior dimensions	FM 2 P	FM 4 P	FM 6 P	FM 8 P
Width (cm)	10	18	18	20
Height (cm)	10	10	12	20
Depth (cm)	20	23	29	20
Interior volume (l)	2	4.3	6.6	8
Temperature data	FM 2 P	FM 4 P	FM 6 P	FM 8 P
heating -up time to 700 °C	30	30	30	30
Max Interim temperature (°C)	1200	1200	1200	1200
Max continuous operating (°C)	1100	1100	1100	1100
Electrical data	FM 2 P	FM 4 P	FM 6 P	FM 8 P
Voltage(V AC)	220	220	220	220
Power (W)	1400	2000	2400	2400
Frequency (HZ)	50	50	50	50
Current (A)	6.4	9.1	10.9	10.9

- All technical data are specified for units with standard equipment at an ambient temperature of 25 °C and voltage of 220±10%.
- The uniform volume is smaller than the total chamber volume

Options

- Over temperature limiter with adjustable cut out temperature for thermal protection class 2 in according with EN605192 as temperature limiter to protect the furnace and load
- Process control and documentation with FG lab software package
- Calibration certificate approved by Institute of Standards



FM series

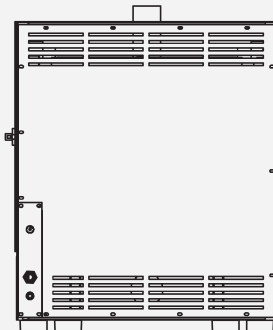
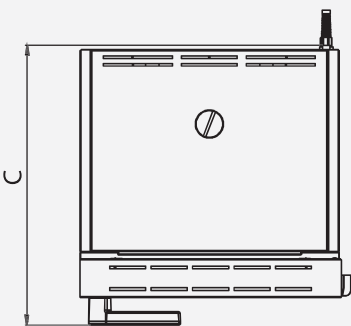
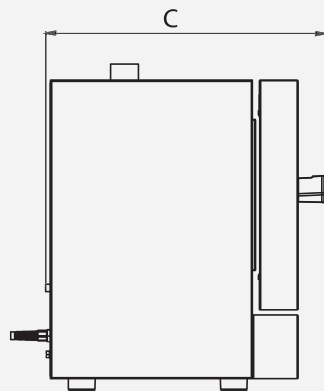
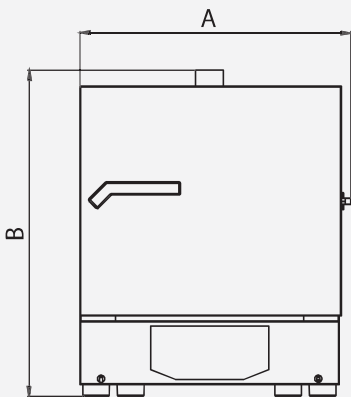

Exterior Information

A	Width
B	Height
C	Depth